

# ANA- QUICK® polyamide conduit type PA6L

PA6L : Light model, for light and medium mechanical strength.

Typ PA6L is a light polyamide conduit for light and medium mechanical strength. The PA6L is very flexible and has a low bending radius. The PA6L is applicable for standard circumstances and for frequent movements. The PA6L is used in light machines and installations in the machine-, equipmentbuilding and in the transportation area.



Construction : Corrugated conduit from modified polyamide PA6, halogen free.

Flame properties : Non-flame propagating.

Resistant against : Alcohol, greases, fuels, mineral oils, weak bases and weak acids.

Temperature range : -40°C till +120°C, intermittent up to +150°C.

Colour : Black.



"Corrugated profile (thin wall)"

|                 |     |     |     |         |     |     |     |     |     |         |
|-----------------|-----|-----|-----|---------|-----|-----|-----|-----|-----|---------|
| Trade size PA6L | mm  | 4,5 | 7,5 | 10      | 12  | 17  | 23  | 29  | 37  | 50      |
| Fittings        | ISO | -   | M10 | M12/M16 | M16 | M20 | M25 | M32 | M40 | M50/M63 |
|                 | PG  | -   | 7   | 9       | 11  | 16  | 21  | 29  | 36  | 48      |

|                                |         |    |           |           |           |           |           |           |           |           |     |
|--------------------------------|---------|----|-----------|-----------|-----------|-----------|-----------|-----------|-----------|-----------|-----|
| Inside diameter                | mm      | -  | 6,9       | 10,2      | 12,5      | 17,0      | 23,5      | 29,4      | 36,7      | 48,1      |     |
| Outside diameter               | mm      | -  | 10,0      | 13,0      | 15,7      | 21,2      | 28,4      | 34,5      | 42,2      | 54,0      |     |
| Bending radius<br>(centerline) | static  | mm | -         | 11        | 18        | 26        | 40        | 50        | 58        | 80        | 90  |
|                                | dynamic | mm | -         | 33        | 54        | 78        | 120       | 150       | 174       | 240       | 270 |
| Standard carton                | m       | -  | 50        | 50        | 50        | 50        | 50        | 25        | 25        | 25        |     |
| Article No. grey               |         | -  | -         | -         | -         | -         | -         | -         | -         | -         |     |
| Article No. black              |         | -  | 801.107.0 | 801.110.0 | 801.112.0 | 801.117.0 | 801.123.0 | 801.129.0 | 801.136.0 | 801.148.0 |     |

| Ana-Quick type PA6L                                | Value | Description                        |
|--|-------|------------------------------------|
| EN 50086 Classification                            |       |                                    |
| Compression resistance                             | 1     | Very light (125 N)                 |
| Impact resistance                                  | 1     | Very light (0,5 J)                 |
| Minimum temperature                                | 4+    | -40°C                              |
| Maximum temperature                                | 4     | +120°C                             |
| Bending resistance                                 | 4     | Flexible                           |
| Electrical properties                              | 0     | None declared                      |
| Resistance to ingress of solid foreign objects (I) | 6     | Protected against dust (dustproof) |
| Resistance to ingress of water (P)                 | 7     | Watertight (1 meter deep, 30 min.) |
| Corrosion resistance inside / outside              | 4     | High / High                        |
| Tensile strength                                   | 1     | Very light (100 N)                 |
| Resistance to flame propagation                    | 1     | Non-flame propagating              |
| Suspended load capacity                            | 0     | None declared                      |

Special remarks:

- \* All sizes PA6L are stock item, please notice for larger volumes a delivery time of 6 till 8 weeks.
- \* Also available in slitted version (Article No. ...7)
- \* Longer lengths available on demand.
- \* Bigger or different sizes available, however no fittings available.



The suitable fittings and accessories for Ana-Quick type PA6L are mentioned on pages 62 till 68.

# ANA- QUICK® polyamide conduit type PA6S

PA6S : Standard model, for medium and heavy mechanical strength.

Typ PA6S is a standard polyamide conduit for medium and heavy mechanical strength. The PA6S is very flexible and has a low bending radius. The PA6S is applicable for standard circumstances and for frequent movements. The PA6S is used in medium and heavy machines and installations in the machine-, equipment-, hospitalbuilding, packagingmachines and the transportation area. Because the PA6S is "UL-Recognized", it is also used for export to countries outside Europe.

Construction : Corrugated conduit from modified polyamide PA6, halogen free.  
 Flame properties : Class HB, according UL-94, flame-retarding.  
 Resistant against : Alcohol, greases, fuels, mineral oils, weak bases and weak acids.

Temperature range : -40°C till +120°C, intermittent up to +150°C.

Colour : Grey and black.

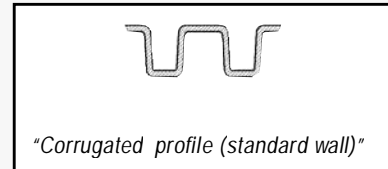

|                 |     |     |     |         |     |     |     |     |     |         |
|-----------------|-----|-----|-----|---------|-----|-----|-----|-----|-----|---------|
| Trade size PA6S | mm  | 4,5 | 7,5 | 10      | 12  | 17  | 23  | 29  | 37  | 50      |
| Fittings        | ISO | -   | M10 | M12/M16 | M16 | M20 | M25 | M32 | M40 | M50/M63 |
|                 | PG  | -   | 7   | 9       | 11  | 16  | 21  | 29  | 36  | 48      |

|                                |         |    |           |           |           |           |           |           |           |           |     |
|--------------------------------|---------|----|-----------|-----------|-----------|-----------|-----------|-----------|-----------|-----------|-----|
| Inside diameter                | mm      | -  | 6,7       | 9,9       | 12,2      | 16,6      | 23,2      | 29,0      | 36,0      | 47,7      |     |
| Outside diameter               | mm      | -  | 10,0      | 13,0      | 15,7      | 21,2      | 28,3      | 34,5      | 42,4      | 54,0      |     |
| Bending radius<br>(centerline) | static  | mm | -         | 13        | 20        | 30        | 45        | 55        | 65        | 90        | 100 |
|                                | dynamic | mm | -         | 39        | 60        | 90        | 135       | 165       | 195       | 270       | 300 |
| Standard carton                | m       | -  | 50        | 50        | 50        | 50        | 50        | 25        | 25        | 25        |     |
| Article No. grey               |         | -  | 801.207.0 | 801.210.0 | 801.212.0 | 801.217.0 | 801.223.0 | 801.229.0 | 801.236.0 | 801.248.0 |     |
| Article No. black              |         | -  | 801.307.0 | 801.310.0 | 801.312.0 | 801.317.0 | 801.323.0 | 801.329.0 | 801.336.0 | 801.348.0 |     |

| Ana-Quick type PA6S                                | Value | Description                        |
|--|-------|------------------------------------|
| EN 50086 Classification                            |       |                                    |
| Compression resistance                             | 2     | Light (320 N)                      |
| Impact resistance                                  | 2     | Light (1 J)                        |
| Minimum temperature                                | 4+    | -40°C                              |
| Maximum temperature                                | 4     | +120°C                             |
| Bending resistance                                 | 4     | Flexible                           |
| Electrical properties                              | 0     | None declared                      |
| Resistance to ingress of solid foreign objects (I) | 6     | Protected against dust (dustproof) |
| Resistance to ingress of water (P)                 | 7     | Watertight (1 meter deep, 30 min.) |
| Corrosion resistance inside / outside              | 4     | High / High                        |
| Tensile strength                                   | 2     | Light (250 N)                      |
| Resistance to flame propagation                    | 1     | Non-flame propagating              |
| Suspended load capacity                            | 0     | None declared                      |

#### Special remarks:

- \* All sizes PA6S are stock item, please notice for larger volumes a delivery time of 6 till 8 weeks.
- \* Also available in slitted version (Article No. ... .7)
- \* Longer lengths available on demand.
- \* Bigger or different sizes available, however no fittings available.



The suitable fittings and accessories for Ana-Quick type PA6S are mentioned on pages 62 till 68.

# ANA- QUICK® polyamide conduit type PA6V0

PA6V0 : Special, self-extinguishing model, for heavy mechanical strength.

Typ PA6V0 is an extra heavy polyamide conduit for high mechanical strength. The PA6V0 is applicable for heavy circumstances and for frequent movements. The PA6V0 is used in heavy machinery, machine- and apparatusbuilding, train area and because PA6V0 is "UL-Recognized" for export especially for countries outside Europe.

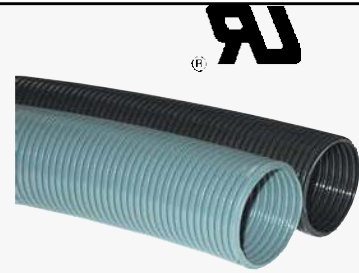

|                   |   |   |
|-------------------|---|---|
| Construction      | : | Corrugated conduit from modified polyamide PA6, halogen free.     |
| Flame properties  | : | Class V0, according UL-94, self-extinguishing.                    |
| Resistant against | : | Alcohol, greases, fuels, mineral oils, weak bases and weak acids. |
| Temperature range | : | -40°C till +120°C, intermittent up to +150°C.                     |
| Colour            | : | Grey and black.   |

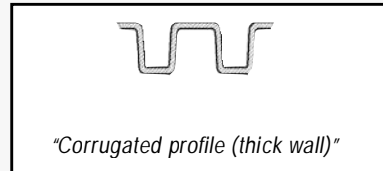

|                  |     |     |     |         |     |     |     |     |     |         |
|------------------|-----|-----|-----|---------|-----|-----|-----|-----|-----|---------|
| Trade size PA6V0 | mm  | 4,5 | 7,5 | 10      | 12  | 17  | 23  | 29  | 37  | 50      |
| Fittings         | ISO | -   | M10 | M12/M16 | M16 | M20 | M25 | M32 | M40 | M50/M63 |
|                  | PG  | -   | 7   | 9       | 11  | 16  | 21  | 29  | 36  | 48      |

|                                |         |    |           |           |           |           |           |           |           |           |
|--------------------------------|---------|----|-----------|-----------|-----------|-----------|-----------|-----------|-----------|-----------|
| Inside diameter                | mm      | -  | 6,7       | 9,6       | 12,1      | 16,2      | 22,7      | 28,4      | 35,5      | 47,8      |
| Outside diameter               | mm      | -  | 10,0      | 13,0      | 15,7      | 21,2      | 28,3      | 34,5      | 42,0      | 54,0      |
| Bending radius<br>(centerline) | static  | mm | -         | 15        | 20        | 30        | 35        | 45        | 65        | 90        |
|                                | dynamic | mm | -         | 45        | 60        | 90        | 105       | 135       | 195       | 270       |
| Standard carton                | m       | -  | 50        | 50        | 50        | 50        | 50        | 25        | 25        | 25        |
| Article No. grey               |         | -  | 801.607.0 | 801.610.0 | 801.612.0 | 801.617.0 | 801.623.0 | 801.629.0 | 801.636.0 | 801.648.0 |
| Article No. black              |         | -  | 801.707.0 | 801.710.0 | 801.712.0 | 801.717.0 | 801.723.0 | 801.729.0 | 801.736.0 | 801.748.0 |

| Ana-Quick type PA6V0                               | Value | Description                        |
|--|-------|------------------------------------|
| EN 50086 Classification                            |       |                                    |
| Compression resistance                             | 3     | Medium (750 N)                     |
| Impact resistance                                  | 3     | Medium (2 J)                       |
| Minimum temperature                                | 4+    | -40°C                              |
| Maximum temperature                                | 4     | +120°C                             |
| Bending resistance                                 | 4     | Flexible                           |
| Electrical properties                              | 0     | None declared                      |
| Resistance to ingress of solid foreign objects (I) | 6     | Protected against dust (dustproof) |
| Resistance to ingress of water (P)                 | 7     | Watertight (1 meter deep, 30 min.) |
| Corrosion resistance inside / outside              | 4     | High / High                        |
| Tensile strength                                   | 3     | Medium (500 N)                     |
| Resistance to flame propagation                    | 1     | Non-flame propagating              |
| Suspended load capacity                            | 0     | None declared                      |

Special remarks:

- \* All sizes PA6V0 in black are limited stock item, please notice for the colour grey and larger volumes a delivery time of 3 till 4 weeks.
- \* Longer lengths available on demand.



The suitable fittings and accessories for Ana-Quick type PA6V0 are mentioned on pages 62 till 68.

# ANA- QUICK® polyamide conduit type PA12S

PA12S : Standard model, for frequent movements.

Typ PA12S is a standard polyamide conduit for normal mechanical strength. The PA12S is very flexible and has a low bending radius. The PA12S is especially for frequent movements. The PA12S is used in robotics or circumstances with a low humidity.



Construction : Corrugated conduit from modified polyamide PA12, halogen free.

Flame properties : Class HB, according UL-94, flame-retarding.

Resistant against : Alcohol, greases, fuels, mineral oils, weak bases and weak acids.

Temperature range : -40°C till +100°C, intermittent from -50°C till +130°C.

Colour : Grey and black.

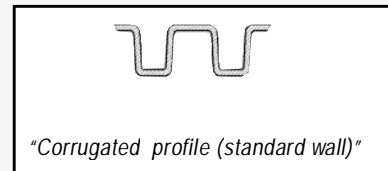

|                  |     |     |     |         |     |     |     |     |     |         |
|------------------|-----|-----|-----|---------|-----|-----|-----|-----|-----|---------|
| Trade size PA12S | mm  | 4,5 | 7,5 | 10      | 12  | 17  | 23  | 29  | 37  | 50      |
| Fittings         | ISO | -   | M10 | M12/M16 | M16 | M20 | M25 | M32 | M40 | M50/M63 |
|                  | PG  | -   | 7   | 9       | 11  | 16  | 21  | 29  | 36  | 48      |

|                                |            |   |           |           |           |           |           |           |           |           |
|--------------------------------|------------|---|-----------|-----------|-----------|-----------|-----------|-----------|-----------|-----------|
| Inside diameter                | mm         | - | 6,9       | 9,9       | 12,2      | 16,6      | 23,2      | 29,0      | 36,0      | 47,7      |
| Outside diameter               | mm         | - | 10,0      | 13,0      | 15,7      | 21,2      | 28,3      | 34,5      | 42,4      | 54,0      |
| Bending radius<br>(centerline) | static mm  | - | 13        | 15        | 22        | 27        | 45        | 50        | 80        | 100       |
|                                | dynamic mm | - | 39        | 45        | 66        | 81        | 135       | 150       | 240       | 300       |
| Standard carton                | m          | - | 50        | 50        | 50        | 50        | 50        | 25        | 25        | 25        |
| Article No. grey               |            | - | 802.407.0 | 802.410.0 | 802.412.0 | 802.417.0 | 802.423.0 | 802.429.0 | 802.436.0 | 802.448.0 |
| Article No. black              |            | - | 802.507.0 | 802.510.0 | 802.512.0 | 802.517.0 | 802.523.0 | 802.529.0 | 802.536.0 | 802.548.0 |

| Ana-Quick type PA12S                               | Value | Description                        |
|--|-------|------------------------------------|
| EN 50086 Classification                            |       |                                    |
| Compression resistance                             | 2     | Light (320 N)                      |
| Impact resistance                                  | 2     | Light (1 J)                        |
| Minimum temperature                                | 4+    | -40°C                              |
| Maximum temperature                                | 2+    | +100°C                             |
| Bending resistance                                 | 4     | Flexible                           |
| Electrical properties                              | 0     | None declared                      |
| Resistance to ingress of solid foreign objects (I) | 6     | Protected against dust (dustproof) |
| Resistance to ingress of water (P)                 | 7     | Watertight (1 meter deep, 30 min.) |
| Corrosion resistance inside / outside              | 4     | High / High                        |
| Tensile strength                                   | 2     | Light (250 N)                      |
| Resistance to flame propagation                    | 1     | Non-flame propagating              |
| Suspended load capacity                            | 0     | None declared                      |

Special remarks:

- \* All sizes PA12S are not a stock item, please notice a delivery time of 3 till 4 weeks.
- \* Longer lengths available on demand.



The suitable fittings and accessories for Ana-Quick type PA12S are mentioned on pages 62 till 68.

# ANA - QUICK FITTINGS PA6, ISO



|            |     |     |     |     |     |     |     |     |     |     |     |
|------------|-----|-----|-----|-----|-----|-----|-----|-----|-----|-----|-----|
| Trade size | mm  | 7,5 | 10  | 10  | 12  | 17  | 23  | 29  | 37  | 50  | 50  |
| Fittings   | ISO | M10 | M12 | M16 | M16 | M20 | M25 | M32 | M40 | M50 | M63 |
|            | PG  | 7   | 9   | -   | 11  | 16  | 21  | 29  | 36  | 48  | -   |



## ISO straight fitting, male, IP 65

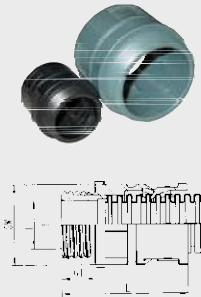

|                   |      |           |           |           |           |           |           |           |           |           |           |
|-------------------|------|-----------|-----------|-----------|-----------|-----------|-----------|-----------|-----------|-----------|-----------|
| ISO thread size   |      | M10x1,0   | M12x1,5   | M16x1,5   | M16x1,5   | M20x1,5   | M25x1,5   | M32x1,5   | M40x1,5   | M50x1,5   | M63x1,5   |
| For Ana-Quick     | NW   | 7,5       | 10        | 10        | 12        | 17        | 23        | 29        | 37        | 50        | 50        |
| Bore (DI)         | mm   | 7,4       | 8,4       | 11,0      | 12,4      | 16,0      | 20,5      | 26,6      | 34,0      | 42,5      | 50,0      |
| Dimensions in mm  | GL   | 9         | 9         | 9         | 9         | 13        | 14        | 14        | 15        | 15        | 15        |
|                   | SW   | 14        | 19        | 19        | 21        | 27        | 36        | 40        | 50        | 65        | 65        |
|                   | L    | 26        | 30        | 29        | 31        | 39        | 44        | 46        | 54        | 58        | 61        |
| Standard pack.    | pcs. | 50        | 50        | 50        | 50        | 50        | 50        | 25        | 25        | 10        | 5         |
| Article No. grey  |      | 803.010.0 | 803.012.0 | 803.016.1 | 803.016.0 | 803.020.0 | 803.025.0 | 803.032.0 | 803.040.0 | 803.050.0 | 803.063.0 |
| Article No. black |      | 803.110.0 | 803.112.0 | 803.116.1 | 803.116.0 | 803.120.0 | 803.125.0 | 803.132.0 | 803.140.0 | 803.150.0 | 803.163.0 |



## ISO 45° elbow fitting, male, IP 65



|                   |      |         |         |         |         |         |           |           |           |           |           |
|-------------------|------|---------|---------|---------|---------|---------|-----------|-----------|-----------|-----------|-----------|
| ISO thread size   |      | M10x1,0 | M12x1,5 | M16x1,5 | M16x1,5 | M20x1,5 | M25x1,5   | M32x1,5   | M40x1,5   | M50x1,5   | M63x1,5   |
| For Ana-Quick     | NW   | -       | -       | -       | -       | -       | 23        | 29        | 37        | 50        | 50        |
| Bore (DI)         | mm   | -       | -       | -       | -       | -       | 20,5      | 26,5      | 33,0      | 42,5      | 48,0      |
| Dimensions in mm  | GL   | -       | -       | -       | -       | -       | 15        | 14        | 16        | 16        | 16        |
|                   | SW   | -       | -       | -       | -       | -       | 36        | 40        | 50        | 65        | 65        |
|                   | L    | -       | -       | -       | -       | -       | 64        | 74        | 86        | 95        | 99        |
| Standard pack.    | pcs. | -       | -       | -       | -       | -       | 50        | 25        | 25        | 10        | 5         |
| Article No. grey  |      | -       | -       | -       | -       | -       | 803.425.0 | 803.432.0 | 803.440.0 | 803.450.0 | 803.463.0 |
| Article No. black |      | -       | -       | -       | -       | -       | 803.525.0 | 803.532.0 | 803.540.0 | 803.550.0 | 803.563.0 |



## ISO 90° elbow fitting, male, IP 65



|                   |      |         |           |           |           |           |           |           |           |           |           |
|-------------------|------|---------|-----------|-----------|-----------|-----------|-----------|-----------|-----------|-----------|-----------|
| ISO thread size   |      | M10x1,0 | M12x1,5   | M16x1,5   | M16x1,5   | M20x1,5   | M25x1,5   | M32x1,5   | M40x1,5   | M50x1,5   | M63x1,5   |
| For Ana-Quick     | NW   | -       | 10        | 10        | 12        | 17        | 23        | 29        | 37        | 50        | 50        |
| Bore (DI)         | mm   | -       | 8,2       | 10,3      | 12,2      | 15,7      | 20,2      | 27,0      | 33,6      | 44,0      | 48,0      |
| Dimensions in mm  | GL   | -       | 9         | 9         | 8         | 10        | 15        | 14        | 15        | 16        | 16        |
|                   | SW   | -       | 19        | 19        | 21        | 27        | 36        | 40        | 50        | 65        | 65        |
|                   | L    | -       | 44        | 44        | 50        | 59        | 78        | 88        | 103       | 126       | 128       |
|                   | H    | -       | 27        | 27        | 30        | 35        | 44        | 52        | 66        | 82        | 85        |
| Standard pack.    | pcs. | -       | 50        | 50        | 50        | 50        | 50        | 25        | 25        | 10        | 5         |
| Article No. grey  |      | -       | 803.812.0 | 803.816.1 | 803.816.0 | 803.820.0 | 803.825.0 | 803.832.0 | 803.840.0 | 803.850.0 | 803.863.0 |
| Article No. black |      | -       | 803.912.0 | 803.916.1 | 803.916.0 | 803.920.0 | 803.925.0 | 803.932.0 | 803.940.0 | 803.950.0 | 803.963.0 |

ANA-QUICK fittings for Polyamide conduit

These IP 65 straight, 45° and 90° fittings have a temperature range of -40°C till +110°C. Material: PA6V0. The cable-hose-version has a temperature range of -20°C till +100°C. Material: PA6V2. In case of the cable-hose-fitting an IP 68 connection on the switchbox is possible. Not mentioned but also available is a straight male M12x1,5 for conduit NW 7,5. Anaconda ISO fittings are available from stock, for larger volumes please notice a delivery time of 3 till 4 weeks. Execution with NPT thread available on demand.

# ANA - QUICK FITTINGS PA6, ISO



|            |     |     |     |     |     |     |     |     |     |     |     |
|------------|-----|-----|-----|-----|-----|-----|-----|-----|-----|-----|-----|
| Trade size | mm  | 7,5 | 10  | 10  | 12  | 17  | 23  | 29  | 37  | 50  | 50  |
| Fittings   | ISO | M10 | M12 | M16 | M16 | M20 | M25 | M32 | M40 | M50 | M63 |
|            | PG  | 7   | 9   | -   | 11  | 16  | 21  | 29  | 36  | 48  | -   |



## ISO straight fitting, female, IP 65



|                   |      |         |         |           |           |           |           |           |         |         |         |
|-------------------|------|---------|---------|-----------|-----------|-----------|-----------|-----------|---------|---------|---------|
| ISO thread size   |      | M10x1,0 | M12x1,5 | M16x1,5   | M16x1,5   | M20x1,5   | M25x1,5   | M32x1,5   | M40x1,5 | M50x1,5 | M63x1,5 |
| For Ana-Quick     | NW   | -       | -       | 10        | 12        | 17        | 23        | 29        | -       | -       | -       |
| Bore (DI)         | mm   | -       | -       | 9,6       | 9,6       | 13,6      | 16,8      | 21,2      | -       | -       | -       |
| Dimensions in mm  | GL   | -       | -       | 20        | 23        | 29        | 39        | 44        | -       | -       | -       |
|                   | SW   | -       | -       | 19        | 21        | 27        | 36        | 40        | -       | -       | -       |
|                   | L    | -       | -       | 35        | 37        | 44        | 47        | 51        | -       | -       | -       |
| Standard pack.    | pcs. | -       | -       | 50        | 50        | 50        | 50        | 25        | -       | -       | -       |
| Article No. grey  |      | -       | -       | 803.216.1 | 803.216.0 | 803.220.0 | 803.225.0 | 803.232.0 | -       | -       | -       |
| Article No. black |      | -       | -       | 803.316.1 | 803.316.0 | 803.320.0 | 803.325.0 | 803.332.0 | -       | -       | -       |

## ISO cable-hose-fitting, male, IP 65



|                   |      |         |         |           |           |           |           |           |         |         |         |
|-------------------|------|---------|---------|-----------|-----------|-----------|-----------|-----------|---------|---------|---------|
| ISO thread size   |      | M10x1,0 | M12x1,5 | M16x1,5   | M16x1,5   | M20x1,5   | M25x1,5   | M32x1,5   | M40x1,5 | M50x1,5 | M63x1,5 |
| For Ana-Quick     | NW   | -       | -       | 10        | 12        | 17        | 23        | 29        | -       | -       | -       |
| Cable min - max   | mm   | -       | -       | 4-10      | 4-10      | 7-14      | 9-16      | 10-21     | -       | -       | -       |
| Dimensions in mm  | GL   | -       | -       | 8         | 8         | 9         | 10        | 10        | -       | -       | -       |
|                   | SW   | -       | -       | 19        | 21        | 27        | 36        | 40        | -       | -       | -       |
|                   | A    | -       | -       | 22        | 23        | 29        | 39        | 44        | -       | -       | -       |
| Standard pack.    | pcs. | -       | -       | 50        | 50        | 50        | 50        | 25        | -       | -       | -       |
| Article No. grey  |      | -       | -       | 805.016.1 | 805.016.0 | 805.020.0 | 805.025.0 | 805.032.0 | -       | -       | -       |
| Article No. black |      | -       | -       | 805.116.1 | 805.116.0 | 805.120.0 | 805.125.0 | 805.132.0 | -       | -       | -       |



## Flange model 90° elbow, fixed, IP 65

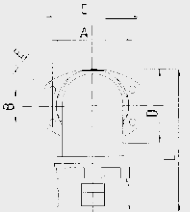
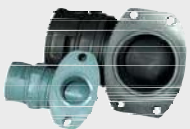

|                   |      |   |       |       |       |           |           |           |           |           |       |
|-------------------|------|---|-------|-------|-------|-----------|-----------|-----------|-----------|-----------|-------|
| Connection size   |      | - | NW 10 | NW 10 | NW 12 | NW 17     | NW 23     | NW 29     | NW 37     | NW 50     | NW 50 |
| For Ana-Quick     | NW   | - | -     | -     | -     | 17        | 23        | 29        | 37        | 50        | -     |
| Bore (DI)         | mm   | - | -     | -     | -     | 16,4      | 22,8      | 27,0      | 38,3      | 47,7      | -     |
| Dimensions in mm  | A    | - | -     | -     | -     | 36        | 53        | 54        | 73        | 73        | -     |
|                   | B    | - | -     | -     | -     | -         | -         | 36        | 30        | 30        | -     |
|                   | C    | - | -     | -     | -     | 46        | 63        | 67        | 86        | 86        | -     |
|                   | E    | - | -     | -     | -     | 5,5       | 6,5       | 6,5       | 6,5       | 6,5       | -     |
| Standard pack.    | pcs. | - | -     | -     | -     | 50        | 50        | 25        | 25        | 10        | -     |
| Article No. grey  |      | - | -     | -     | -     | 808.416.0 | 808.421.0 | 808.429.0 | 808.436.0 | 808.448.0 | -     |
| Article No. black |      | - | -     | -     | -     | 808.516.0 | 808.521.0 | 808.529.0 | 808.536.0 | 808.548.0 | -     |

ANA-QUICK fittings for Polyamide conduit

These IP 65 straight and 90° fittings have a temperature range of -40°C till +110°C. Material: PA6V0. The cable-hose-version has a temperature range of -20°C till +100°C. Material: PA6V2. In case of the cable-hose-fitting an IP 68 connection on the switchbox is possible. Anaconda ISO fittings are limited available from stock, for larger volumes please notice a delivery time of 4 till 6 weeks.

# ANA - QUICK FITTINGS PA6, ISO



|            |     |     |     |     |     |     |     |     |     |     |     |
|------------|-----|-----|-----|-----|-----|-----|-----|-----|-----|-----|-----|
| Trade size | mm  | 7,5 | 10  | 10  | 12  | 17  | 23  | 29  | 37  | 50  | 50  |
| Fittings   | ISO | M10 | M12 | M16 | M16 | M20 | M25 | M32 | M40 | M50 | M63 |
|            | PG  | 7   | 9   | -   | 11  | 16  | 21  | 29  | 36  | 48  | -   |



## ISO straight fitting, male, nickel plated thread, IP 65

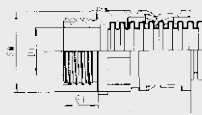

|                   |      |         |           |           |           |           |           |           |           |           |           |
|-------------------|------|---------|-----------|-----------|-----------|-----------|-----------|-----------|-----------|-----------|-----------|
| ISO thread size   |      | M10x1,0 | M12x1,5   | M16x1,5   | M16x1,5   | M20x1,5   | M25x1,5   | M32x1,5   | M40x1,5   | M50x1,5   | M63x1,5   |
| For Ana-Quick     | NW   | -       | 10        | 10        | 12        | 17        | 23        | 29        | 37        | 50        | 50        |
| Bore (DI)         | mm   | -       | 6,8       | 10,0      | 10,3      | 14,6      | 18,6      | 24,0      | 32,2      | 41,6      | 47,0      |
| Dimensions in mm  | GL   | -       | 10        | 10        | 10        | 12        | 15        | 15        | 16        | 16        | 16        |
|                   | SW   | -       | 19        | 19        | 21        | 27        | 36        | 40        | 50        | 65        | 65        |
|                   | L    | -       | 33        | 35        | 37        | 42        | 48        | 53        | 59        | 65        | 65        |
| Standard pack.    | pcs. | -       | 50        | 50        | 50        | 50        | 50        | 25        | 25        | 10        | 5         |
| Article No. grey  |      | -       | 807.012.0 | 807.016.1 | 807.016.0 | 807.020.0 | 807.025.0 | 807.032.0 | 807.040.0 | 807.050.0 | 807.063.0 |
| Article No. black |      | -       | 807.112.0 | 807.116.1 | 807.116.0 | 807.120.0 | 807.125.0 | 807.132.0 | 807.140.0 | 807.150.0 | 807.163.0 |



## ISO 45° elbow fitting, male, nickel plated thread, IP 65

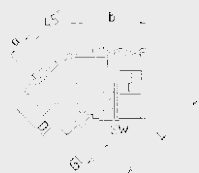

|                   |      |         |         |         |         |         |           |           |           |           |           |
|-------------------|------|---------|---------|---------|---------|---------|-----------|-----------|-----------|-----------|-----------|
| ISO thread size   |      | M10x1,0 | M12x1,5 | M16x1,5 | M16x1,5 | M20x1,5 | M25x1,5   | M32x1,5   | M40x1,5   | M50x1,5   | M63x1,5   |
| For Ana-Quick     | NW   | -       | -       | -       | -       | -       | 23        | 29        | 37        | 50        | 50        |
| Bore (DI)         | mm   | -       | -       | -       | -       | -       | 19,0      | 23,8      | 32,0      | 41,5      | 47,0      |
| Dimensions in mm  | GL   | -       | -       | -       | -       | -       | 15        | 15        | 16        | 16        | 16        |
|                   | SW   | -       | -       | -       | -       | -       | 36        | 40        | 50        | 65        | 65        |
|                   | L    | -       | -       | -       | -       | -       | 64        | 76        | 88        | 95        | 95        |
| Standard pack.    | pcs. | -       | -       | -       | -       | -       | 50        | 25        | 25        | 10        | 5         |
| Article No. grey  |      | -       | -       | -       | -       | -       | 807.425.0 | 807.432.0 | 807.440.0 | 807.450.0 | 807.463.0 |
| Article No. black |      | -       | -       | -       | -       | -       | 807.525.0 | 807.532.0 | 807.540.0 | 807.550.0 | 807.563.0 |



## ISO 90° elbow fitting, male, nickel plated thread, IP 65



|                   |      |         |           |           |           |           |           |           |           |           |           |
|-------------------|------|---------|-----------|-----------|-----------|-----------|-----------|-----------|-----------|-----------|-----------|
| ISO thread size   |      | M10x1,0 | M12x1,5   | M16x1,5   | M16x1,5   | M20x1,5   | M25x1,5   | M32x1,5   | M40x1,5   | M50x1,5   | M63x1,5   |
| For Ana-Quick     | NW   | -       | 10        | 10        | 12        | 17        | 23        | 29        | 37        | 50        | 50        |
| Bore (DI)         | mm   | -       | 6,9       | 10,1      | 10,5      | 15,0      | 18,0      | 23,7      | 32,5      | 37,7      | 47,0      |
| Dimensions in mm  | GL   | -       | 10        | 10        | 10        | 12        | 15        | 15        | 16        | 16        | 16        |
|                   | SW   | -       | 19        | 19        | 21        | 27        | 36        | 40        | 50        | 65        | 65        |
|                   | L    | -       | 45        | 45        | 50        | 59        | 78        | 88        | 103       | 126       | 128       |
|                   | H    | -       | 27        | 27        | 30        | 35        | 44        | 52        | 66        | 82        | 85        |
| Standard pack.    | pcs. | -       | 50        | 50        | 50        | 50        | 50        | 25        | 25        | 10        | 5         |
| Article No. grey  |      | -       | 807.812.0 | 807.816.1 | 807.816.0 | 807.820.0 | 807.825.0 | 807.832.0 | 807.840.0 | 807.850.0 | 807.863.0 |
| Article No. black |      | -       | 807.912.0 | 807.916.1 | 807.916.0 | 807.920.0 | 807.925.0 | 807.932.0 | 807.940.0 | 807.950.0 | 807.963.0 |

ANA-QUICK fittings for Polyamide conduit

These IP 65 straight, 45° and 90° fittings have a temperature range of -40°C till +110°C. Material: PA6V0. Ana-Quick ISO fittings, with nickel plated thread, are not available from stock, please notice a delivery time (on request). Also available but not mentioned are PG, IP65, straight, 45° and 90° fittings with nickel plated thread and EMC/EMP connections.

# ANA-QUICK ACCESSORIES PA6, ISO

|            |     |     |     |     |     |     |     |     |     |     |
|------------|-----|-----|-----|-----|-----|-----|-----|-----|-----|-----|
| Trade size | mm  | 7,5 | 10  | 12  | 17  | 23  | 29  | 37  | 50  | 50  |
| Fittings   | ISO | M10 | M12 | M16 | M20 | M25 | M32 | M40 | M50 | M63 |
|            | PG  | 7   | 9   | 11  | 16  | 21  | 29  | 36  | 48  | -   |

## ISO locknut, glassfibre reinforced polyamide



|                   |      |           |           |           |           |           |           |           |           |           |
|-------------------|------|-----------|-----------|-----------|-----------|-----------|-----------|-----------|-----------|-----------|
| ISO thread        |      | M10x1,5   | M12x1,5   | M16x1,5   | M20x1,5   | M25x1,5   | M32x1,5   | M40x1,5   | M50x1,5   | M63x1,5   |
| Standard pack.    | pcs. | 50        | 50        | 50        | 50        | 20        | 20        | 20        | 10        | 5         |
| Article No. grey  |      | 798.310.0 | 798.312.0 | 798.316.0 | 798.320.0 | 798.325.0 | 798.332.0 | 798.340.0 | 798.350.0 | 798.363.0 |
| Article No. black |      | 798.310.3 | 798.312.3 | 798.316.3 | 798.320.3 | 798.325.3 | 798.332.3 | 798.340.3 | 798.350.3 | 798.363.3 |

## ISO locknut, nickel plated brass



|                |      |   |           |           |           |           |           |           |           |           |
|----------------|------|---|-----------|-----------|-----------|-----------|-----------|-----------|-----------|-----------|
| ISO thread     |      | - | M12x1,5   | M16x1,5   | M20x1,5   | M25x1,5   | M32x1,5   | M40x1,5   | M50x1,5   | M63x1,5   |
| Dimension SW   | mm   | - | 15        | 20        | 24        | 30        | 35        | 45        | 55        | 70        |
| Standard pack. | pcs. | - | 50        | 50        | 50        | 25        | 20        | 10        | 10        | 5         |
| Article No.    |      | - | 880.112.0 | 880.116.0 | 880.120.0 | 880.125.0 | 880.132.0 | 880.140.0 | 880.150.0 | 880.163.0 |

## ISO reducer, glassfibre reinforced polyamide

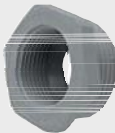

|                    |      |   |   |           |           |           |           |           |           |           |
|--------------------|------|---|---|-----------|-----------|-----------|-----------|-----------|-----------|-----------|
| ISO thread outside |      | - | - | M16x1,5   | M20x1,5   | M25x1,5   | M32x1,5   | M40x1,5   | M50x1,5   | M63x1,5   |
| ISO thread inside  |      | - | - | M12x1,5   | M16x1,5   | M20x1,5   | M25x1,5   | M32x1,5   | M40x1,5   | M50x1,5   |
| Standard pack.     | pcs. | - | - | 50        | 50        | 50        | 20        | 20        | 10        | 5         |
| Article No. grey   |      | - | - | 266.416.0 | 266.420.0 | 266.425.0 | 266.432.0 | 266.440.0 | 266.450.0 | 266.463.0 |

## ISO enlarger, glassfibre reinforced polyamide



|                    |      |   |           |           |           |           |           |           |           |   |
|--------------------|------|---|-----------|-----------|-----------|-----------|-----------|-----------|-----------|---|
| ISO thread outside |      | - | M12x1,5   | M16x1,5   | M20x1,5   | M25x1,5   | M32x1,5   | M40x1,5   | M50x1,5   | - |
| ISO thread inside  |      | - | M16x1,5   | M20x1,5   | M25x1,5   | M32x1,5   | M40x1,5   | M50x1,5   | M63x1,5   | - |
| Standard pack.     | pcs. | - | 50        | 50        | 50        | 20        | 20        | 20        | 10        | - |
| Article No. grey   |      | - | 266.512.0 | 266.516.0 | 266.520.0 | 266.525.0 | 266.532.0 | 266.540.0 | 266.550.0 | - |

## PG-ISO adapter, glassfibre reinforced polyamide



|                   |      |   |   |           |           |           |           |   |   |   |
|-------------------|------|---|---|-----------|-----------|-----------|-----------|---|---|---|
| PG thread outside |      | - | - | 16        | 21        | 21        | 29        | - | - | - |
| ISO thread inside |      | - | - | M20x1,5   | M20x1,5   | M25x1,5   | M25x1,5   | - | - | - |
| Standard pack.    | pcs. | - | - | 50        | 50        | 50        | 25        | - | - | - |
| Article No. grey  |      | - | - | 266.316.0 | 266.321.0 | 266.322.0 | 266.329.0 | - | - | - |

## ISO plug, round, glassfibre reinforced polyamide



|                  |      |   |           |           |           |           |           |           |           |           |
|------------------|------|---|-----------|-----------|-----------|-----------|-----------|-----------|-----------|-----------|
| ISO thread       |      | - | M12x1,5   | M16x1,5   | M20x1,5   | M25x1,5   | M32x1,5   | M40x1,5   | M50x1,5   | M63x1,5   |
| Dimension SW     | mm   | - | -         | -         | -         | -         | -         | -         | -         | -         |
| Standard pack.   | pcs. | - | 50        | 50        | 50        | 20        | 20        | 20        | 10        | 5         |
| Article No. grey |      | - | 266.612.0 | 266.616.0 | 266.620.0 | 266.625.0 | 266.632.0 | 266.640.0 | 266.650.0 | 266.663.0 |

Accessories for fittings for Ana-Quick polyamide conduit

Above mentioned accessories have a temperature range of -30°C till +120°C. Material: Polyamide PA6 in combination with glassfibre 25%. All articles are no stock item and have a delivery time of 2 till 3 weeks.



# ANA - QUICK FITTINGS PA6, PG



|            |     |     |     |     |      |     |     |     |     |     |     |
|------------|-----|-----|-----|-----|------|-----|-----|-----|-----|-----|-----|
| Trade size | mm  | 7,5 | 10  | 12  | 17   | 17  | 23  | 29  | 37  | 50  | 50  |
| Fittings   | ISO | M10 | M12 | M16 | -    | M20 | M25 | M32 | M40 | M50 | M63 |
|            | PG  | 7   | 9   | 11  | 13,5 | 16  | 21  | 29  | 36  | 48  | -   |



## PG straight fitting, male, IP 65



|                   |      |           |           |           |           |           |           |           |           |           |   |
|-------------------|------|-----------|-----------|-----------|-----------|-----------|-----------|-----------|-----------|-----------|---|
| PG thread size    |      | 7         | 9         | 11        | 13,5      | 16        | 21        | 29        | 36        | 48        | - |
| For Ana-Quick     | NW   | 7,5       | 10        | 12        | 17        | 17        | 23        | 29        | 37        | 50        | - |
| Bore (DI)         | mm   | 8,5       | 10,5      | 13,0      | 14,9      | 16,5      | 23,1      | 29,2      | 37,5      | 49,1      | - |
| Dimensions in mm  | GL   | 7         | 8         | 8         | 10        | 10        | 12        | 12        | 15        | 15        | - |
|                   | SW   | 14        | 19        | 21        | 27        | 27        | 36        | 40        | 50        | 65        | - |
|                   | L    | 24        | 28        | 31        | 36        | 36        | 41        | 43        | 54        | 58        | - |
| Standard pack.    | pcs. | 50        | 50        | 50        | 50        | 50        | 50        | 25        | 25        | 10        | - |
| Article No. grey  |      | 804.007.0 | 804.009.0 | 804.011.0 | 804.013.0 | 804.016.0 | 804.021.0 | 804.029.0 | 804.036.0 | 804.048.0 | - |
| Article No. black |      | 804.107.0 | 804.109.0 | 804.111.0 | 804.113.0 | 804.116.0 | 804.121.0 | 804.129.0 | 804.136.0 | 804.148.0 | - |



## PG 45° elbow fitting, male, IP 65

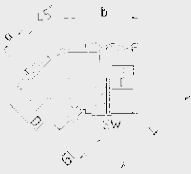

|                   |      |   |   |    |      |    |           |           |           |           |   |
|-------------------|------|---|---|----|------|----|-----------|-----------|-----------|-----------|---|
| PG thread size    |      | 7 | 9 | 11 | 13,5 | 16 | 21        | 29        | 36        | 48        | - |
| For Ana-Quick     | NW   | - | - | -  | -    | -  | 23        | 29        | 37        | 50        | - |
| Bore (DI)         | mm   | - | - | -  | -    | -  | 22,5      | 27,0      | 39,0      | 48,0      | - |
| Dimensions in mm  | GL   | - | - | -  | -    | -  | 12        | 12        | 16        | 16        | - |
|                   | SW   | - | - | -  | -    | -  | 36        | 40        | 50        | 65        | - |
|                   | L    | - | - | -  | -    | -  | 64        | 75        | 87        | 96        | - |
| Standard pack.    | pcs. | - | - | -  | -    | -  | 50        | 25        | 25        | 10        | - |
| Article No. grey  |      | - | - | -  | -    | -  | 804.421.0 | 804.429.0 | 804.436.0 | 804.448.0 | - |
| Article No. black |      | - | - | -  | -    | -  | 804.521.0 | 804.529.0 | 804.536.0 | 804.548.0 | - |



## PG 90° elbow fitting, male, IP 65

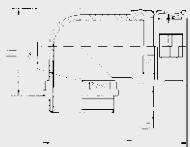

|                   |      |     |           |           |           |           |           |           |           |           |   |
|-------------------|------|-----|-----------|-----------|-----------|-----------|-----------|-----------|-----------|-----------|---|
| PG thread size    |      | 7   | 9         | 11        | 13,5      | 16        | 21        | 29        | 36        | 48        | - |
| For Ana-Quick     | NW   | 7,5 | 10        | 12        | 17        | 17        | 23        | 29        | 37        | 50        | - |
| Bore (DI)         | mm   | -   | 10,2      | 12,0      | 15,7      | 15,7      | 22,7      | 26,6      | 37,8      | 47,7      | - |
| Dimensions in mm  | GL   | -   | 9         | 8         | 10        | 10        | 12        | 12        | 16        | 16        | - |
|                   | SW   | -   | 19        | 21        | 27        | 27        | 36        | 40        | 50        | 65        | - |
|                   | L    | -   | 45        | 50        | 59        | 59        | 78        | 88        | 103       | 126       | - |
|                   | H    | -   | 27        | 30        | 35        | 35        | 44        | 52        | 67        | 82        | - |
| Standard pack.    | pcs. | -   | 50        | 50        | 50        | 50        | 50        | 25        | 25        | 10        | - |
| Article No. grey  |      | -   | 804.809.0 | 804.811.0 | 804.813.0 | 804.816.0 | 804.821.0 | 804.829.0 | 804.836.0 | 804.848.0 | - |
| Article No. black |      | -   | 804.909.0 | 804.911.0 | 804.913.0 | 804.916.0 | 804.921.0 | 804.929.0 | 804.936.0 | 804.948.0 | - |

ANA-QUICK fittings for Polyamide conduit

These IP 65 straight, 45° and 90° fittings have a temperature range of -40°C till +110°C. Material: PA6V0. Not mentioned but also available is a straight male PG 9 for conduit NW 7,5. Anaconda PG fittings are available from stock, for larger volumes please notice a delivery time of 3 till 4 weeks.

# ANA-QUICK ACCESSORIES PA6, ISO

|            |     |     |     |     |     |     |     |     |     |     |
|------------|-----|-----|-----|-----|-----|-----|-----|-----|-----|-----|
| Trade size | mm  | 7,5 | 10  | 12  | 17  | 23  | 29  | 37  | 50  | 50  |
| Fittings   | ISO | M10 | M12 | M16 | M20 | M25 | M32 | M40 | M50 | M63 |
|            | PG  | 7   | 9   | 11  | 16  | 21  | 29  | 36  | 48  | -   |

## PG locknut, glassfibre reinforced polyamide



|                   |      |           |           |           |           |           |           |           |           |   |
|-------------------|------|-----------|-----------|-----------|-----------|-----------|-----------|-----------|-----------|---|
| PG thread         |      | 7         | 9         | 11        | 16        | 21        | 29        | 36        | 48        | - |
| Standard pack.    | pcs. | 50        | 50        | 50        | 50        | 20        | 20        | 10        | 5         | - |
| Article No. grey  |      | 269.907.0 | 269.909.0 | 269.911.0 | 269.916.0 | 269.921.0 | 269.929.0 | 269.936.0 | 269.948.0 | - |
| Article No. black |      | 269.907.3 | 269.909.3 | 269.911.3 | 269.916.3 | 269.921.3 | 269.929.3 | 269.936.3 | 269.948.3 | - |

## PG locknut, nickel plated brass



|                |      |           |           |           |           |           |           |           |           |   |
|----------------|------|-----------|-----------|-----------|-----------|-----------|-----------|-----------|-----------|---|
| PG thread      |      | 7         | 9         | 11        | 16        | 21        | 29        | 36        | 48        | - |
| Dimension SW   | mm   | 15        | 18        | 21        | 26        | 32        | 41        | 51        | 64        | - |
| Standard pack. | pcs. | 100       | 100       | 100       | 100       | 100       | 100       | 50        | 50        | - |
| Article No.    |      | 880.007.0 | 880.009.0 | 880.011.0 | 880.016.0 | 880.021.0 | 880.029.0 | 880.036.0 | 880.048.0 | - |

## PG reducer, glassfibre reinforced polyamide



|                   |      |   |           |           |           |           |           |           |           |           |
|-------------------|------|---|-----------|-----------|-----------|-----------|-----------|-----------|-----------|-----------|
| PG thread outside |      | - | 9         | 11        | 16        | 21        | 29        | 36        | 42        | 48        |
| PG thread inside  |      | - | 7         | 9         | 11        | 16        | 21        | 29        | 36        | 42        |
| Standard pack.    | pcs. | - | 100       | 100       | 100       | 100       | 50        | 50        | 25        | 25        |
| Article No. grey  |      | - | 266.109.0 | 266.111.0 | 266.116.0 | 266.121.0 | 266.129.0 | 266.236.0 | 266.242.0 | 266.248.0 |

## PG enlarger, glassfibre reinforced polyamide



|                   |      |           |           |           |           |           |           |           |           |   |
|-------------------|------|-----------|-----------|-----------|-----------|-----------|-----------|-----------|-----------|---|
| PG thread outside |      | 7         | 9         | 11        | 16        | 21        | 29        | 36        | 42        | - |
| PG thread inside  |      | 9         | 11        | 16        | 21        | 29        | 36        | 42        | 48        | - |
| Standard pack.    | pcs. | 100       | 100       | 100       | 100       | 50        | 25        | 10        | 10        | - |
| Article No. grey  |      | 266.207.0 | 266.209.0 | 266.211.0 | 266.216.0 | 266.221.0 | 266.229.0 | 266.236.0 | 266.242.0 | - |

## Neoprene end-sleeve, with traction relieve, IP 54



|                   |      |   |   |           |           |           |           |           |           |   |
|-------------------|------|---|---|-----------|-----------|-----------|-----------|-----------|-----------|---|
| For Ana-quick     | NW   | - | - | 12        | 17        | 23        | 29        | 37        | 50        | - |
| Cable min-max     | mm   | - | - | 4-9       | 5-12      | 7-17      | 9-20      | 16-30     | 23-40     | - |
| Standard pack.    | pcs. | - | - | 3000      | 2400      | 1200      | 800       | 800       | 500       | - |
| Article No. black |      | - | - | 266.812.0 | 266.817.0 | 266.823.0 | 266.829.0 | 266.836.0 | 266.842.0 | - |

## PG plug, round, glassfibre reinforced polyamide



|                  |      |           |           |           |           |           |           |           |           |   |
|------------------|------|-----------|-----------|-----------|-----------|-----------|-----------|-----------|-----------|---|
| PG thread        |      | 7         | 9         | 11        | 16        | 21        | 29        | 36        | 48        | - |
| Dimension SW     | mm   | -         | -         | -         | -         | -         | -         | -         | -         | - |
| Standard pack.   | pcs. | 100       | 100       | 100       | 100       | 100       | 50        | 50        | 50        | - |
| Article No. grey |      | 266.707.0 | 266.709.0 | 266.711.0 | 266.716.0 | 266.721.0 | 266.729.0 | 266.736.0 | 266.748.0 | - |

Accessories for fittings for Ana-Quick polyamide conduit

Above mentioned accessories have a temperature range of -30°C till +120°C. Material: Polyamide PA6 in combination with glassfibre 25%. All articles are no stock item and have a delivery time of 2 till 3 weeks.

# ANA-QUICK ACCESSORIES, PA6

|            |     |     |     |     |     |     |     |     |     |     |
|------------|-----|-----|-----|-----|-----|-----|-----|-----|-----|-----|
| Trade size | mm  | 7,5 | 10  | 12  | 17  | 23  | 29  | 37  | 50  | 50  |
| Fittings   | ISO | M10 | M12 | M16 | M20 | M25 | M32 | M40 | M50 | M63 |
|            | PG  | 7   | 9   | 11  | 16  | 21  | 29  | 36  | 48  | -   |

## Conduit saddle, without cover, for ANA-QUICK conduit



|                      |      |           |           |           |           |           |           |           |           |   |
|----------------------|------|-----------|-----------|-----------|-----------|-----------|-----------|-----------|-----------|---|
| Ana-Quick conduit NW |      | NW 7      | NW 10     | NW 12     | NW 17     | NW 23     | NW 29     | NW 37     | NW 50     | - |
| Standard pack.       | pcs. | 50        | 50        | 50        | 50        | 50        | 50        | 50        | 50        | - |
| Article No. grey     |      | 809.407.0 | 809.410.0 | 809.412.0 | 809.417.0 | 809.423.0 | 809.429.0 | 809.436.0 | 809.448.0 | - |
| Article No. black    |      | 809.507.0 | 809.510.0 | 809.512.0 | 809.517.0 | 809.523.0 | 809.529.0 | 809.536.0 | 809.548.0 | - |

## Cover, for conduit saddle, for ANA-QUICK conduit



|                      |      |           |           |           |           |           |           |           |           |   |
|----------------------|------|-----------|-----------|-----------|-----------|-----------|-----------|-----------|-----------|---|
| Ana-Quick conduit NW |      | 7,5       | 10        | 12        | 17        | 23        | 29        | 37        | 50        | - |
| Standard pack.       | pcs. | 50        | 50        | 50        | 50        | 50        | 50        | 50        | 50        | - |
| Article No. grey     |      | 809.607.0 | 809.610.0 | 809.612.0 | 809.617.0 | 809.623.0 | 809.629.0 | 809.636.0 | 809.648.0 | - |
| Article No. black    |      | 809.707.0 | 809.710.0 | 809.712.0 | 809.717.0 | 809.723.0 | 809.729.0 | 809.736.0 | 809.748.0 | - |

## T - joint, conduit at outside connected, IP 40

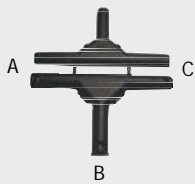

|                   |      |   |           |           |           |           |           |           |   |   |
|-------------------|------|---|-----------|-----------|-----------|-----------|-----------|-----------|---|---|
| Type              |      | - | 10-10-10  | 17-17-10  | 17-17-17  | 23-23-10  | 23-23-17  | 23-23-23  | - | - |
| Ana-quick size A  | NW   | - | 10        | 17        | 17        | 23        | 23        | 23        | - | - |
| Ana-quick size B  | NW   | - | 10        | 17        | 17        | 23        | 23        | 23        | - | - |
| Ana-quick size C  | NW   | - | 10        | 10        | 17        | 10        | 17        | 23        | - | - |
| Standard pack.    | pcs. | - | 100       | 100       | 100       | 100       | 100       | 100       | - | - |
| Article No. black |      | - | 799.801.0 | 799.802.0 | 799.803.0 | 799.804.0 | 799.805.0 | 799.806.0 | - | - |

## T - joint, conduit at inside connected, IP 40

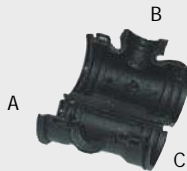

|                   |      |           |           |           |           |           |           |           |           |           |
|-------------------|------|-----------|-----------|-----------|-----------|-----------|-----------|-----------|-----------|-----------|
| Type              |      | 7-7-7     | 10-10-10  | 12-10-10  | 12-10-12  | 12-12-10  | 12-12-12  | 17-12-12  | 17-12-17  | 23-23-23  |
| Ana-quick size A  | NW   | 7,5       | 10        | 12        | 12        | 12        | 12        | 17        | 17        | 23        |
| Ana-quick size B  | NW   | 7,5       | 10        | 10        | 10        | 12        | 12        | 12        | 12        | 23        |
| Ana-quick size C  | NW   | 7,5       | 10        | 10        | 12        | 10        | 12        | 12        | 17        | 23        |
| Standard pack.    | pcs. | 10        | 10        | 10        | 10        | 10        | 10        | 10        | 10        | 10        |
| Article No. black |      | 799.601.0 | 799.605.0 | 799.606.0 | 799.607.0 | 799.608.0 | 799.609.0 | 799.610.0 | 799.611.0 | 799.616.0 |

## Y - joint, conduit at outside connected, IP 40



|                   |      |           |           |           |           |           |           |           |           |   |
|-------------------|------|-----------|-----------|-----------|-----------|-----------|-----------|-----------|-----------|---|
| Type              |      | 7-7-7     | 10-10-10  | 12-10-12  | 12-12-12  | 17-12-17  | 17-17-10  | 23-17-17  | 23-23-23  | - |
| Ana-quick size A  | NW   | 7,5       | 10        | 12        | 12        | 17        | 17        | 23        | 23        | - |
| Ana-quick size B  | NW   | 7,5       | 10        | 10        | 12        | 12        | 17        | 17        | 23        | - |
| Ana-quick size C  | NW   | 7,5       | 10        | 12        | 12        | 17        | 10        | 17        | 23        | - |
| Standard pack.    | pcs. | 500       | 500       | 500       | 500       | 500       | 500       | 500       | 250       | - |
| Article No. black |      | 799.901.0 | 799.902.0 | 799.903.0 | 799.904.0 | 799.905.0 | 799.906.0 | 799.907.0 | 799.908.0 | - |

## Y - joint, conduit at inside connected, IP 40



|                   |      |           |           |           |           |           |           |           |           |   |
|-------------------|------|-----------|-----------|-----------|-----------|-----------|-----------|-----------|-----------|---|
| Type              |      | 7-7-7     | 10-10-10  | 12-10-10  | 12-12-10  | 12-12-12  | 17-12-17  | 23-17-12  | 23-23-23  | - |
| Ana-quick size A  | NW   | 7,5       | 10        | 12        | 12        | 12        | 17        | 23        | 23        | - |
| Ana-quick size B  | NW   | 7,5       | 10        | 10        | 12        | 12        | 12        | 17        | 23        | - |
| Ana-quick size C  | NW   | 7,5       | 10        | 10        | 10        | 12        | 17        | 12        | 23        | - |
| Standard pack.    | pcs. | 10        | 10        | 10        | 10        | 10        | 10        | 10        | 10        | - |
| Article No. black |      | 799.701.0 | 799.705.0 | 799.706.0 | 799.708.0 | 799.709.0 | 799.711.0 | 799.714.0 | 799.716.0 | - |

Accessories for Ana-Quick polyamide conduit

The Ana-quick conduit holders and covers have a temperature range of -40°C till +110°C. Material: Polyamide PA6V0. The conduit T-Y joints have a temperature range of -40°C till +130°C. Material PA 6. Conduit holders are stock item, all other articles are no stock item and have a delivery time of 2 till 3 weeks.

# "GIGANT" conduit & fittings , PA6

|            |     |    |    |   |   |   |   |   |
|------------|-----|----|----|---|---|---|---|---|
| Trade size | mm  | 70 | 95 | - | - | - | - | - |
| Fittings   | ISO | 70 | 95 | - | - | - | - | - |
|            | PG  | -  | -  | - | - | - | - | - |

## "GIGANT" conduit PA6



|                        |    |           |           |   |   |   |   |   |
|------------------------|----|-----------|-----------|---|---|---|---|---|
| Trade size             | NW | 70        | 95        | - | - | - | - | - |
| Flange connection      |    | 70        | 95        | - | - | - | - | - |
| Inside diameter        | mm | 67,5      | 91,5      | - | - | - | - | - |
| Outside diameter       | mm | 80,0      | 106,0     | - | - | - | - | - |
| Bendingradius (static) | mm | 106       | 210       | - | - | - | - | - |
| Standard pack.         | m  | 10        | 10        | - | - | - | - | - |
| Article No. grey       |    | 301.070.1 | 301.099.1 | - | - | - | - | - |
| Article No. black      |    | 301.170.1 | 301.199.1 | - | - | - | - | - |

## "GIGANT" straight flange connection, IP 40

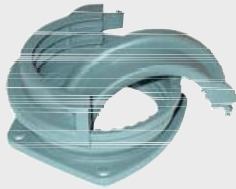

|                     |        |           |           |   |   |   |   |   |
|---------------------|--------|-----------|-----------|---|---|---|---|---|
| Trade size          | NW     | 70        | 95        | - | - | - | - | - |
| Flange connection   |        | 70        | 95        | - | - | - | - | - |
| Flange diameter (F) | mm     | 106       | 132       | - | - | - | - | - |
| Dimensions in       | m      | 60        | 74        | - | - | - | - | - |
|                     | B      | 80        | 108       | - | - | - | - | - |
|                     | C      | 98        | 126       | - | - | - | - | - |
|                     | D      | 52,5      | 52,5      | - | - | - | - | - |
|                     | Ø - mm | 7,0       | 7,0       | - | - | - | - | - |
| Standard pack.      | pcs.   | 1         | 1         | - | - | - | - | - |
| Article No. grey    |        | 269.070.3 | 269.099.3 | - | - | - | - | - |
| Article No. black   |        | 269.170.3 | 269.199.3 | - | - | - | - | - |

## "GIGANT" 90° flange connection, IP 40

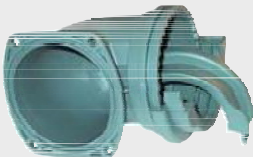

|                     |        |           |           |   |   |   |   |   |
|---------------------|--------|-----------|-----------|---|---|---|---|---|
| Trade size          | NW     | 70        | 95        | - | - | - | - | - |
| Flange connection   |        | 70        | 95        | - | - | - | - | - |
| Flange diameter (C) | mm     | 96        | 126       | - | - | - | - | - |
| Dimensions in       | m      | 6         | 74        | - | - | - | - | - |
|                     | B      | 80        | 108       | - | - | - | - | - |
|                     | D      | 128       | 166       | - | - | - | - | - |
|                     | F      | 110,5     | 144,0     | - | - | - | - | - |
|                     | Ø - mm | 7,0       | 7,0       | - | - | - | - | - |
| Standard pack.      | pcs.   | 1         | 1         | - | - | - | - | - |
| Article No. grey    |        | 269.270.3 | 269.299.3 | - | - | - | - | - |
| Article No. black   |        | 269.370.3 | 269.399.3 | - | - | - | - | - |

## "GIGANT" sealing (improves IP rate to IP 65)



|                   |      |           |           |   |   |   |   |   |
|-------------------|------|-----------|-----------|---|---|---|---|---|
| Trade size        | NW   | 70        | 95        | - | - | - | - | - |
| Flange diameter   | mm   | 106       | 132       | - | - | - | - | - |
| Standard pack.    | pcs. | 1         | 1         | - | - | - | - | - |
| Article No. black |      | 269.870.1 | 269.899.1 | - | - | - | - | - |

"GIGANT" conduit and fittings

The Anamet "Gigant" conduit and fittings have a temperature range of -40°C till +120°C. Material: Polyamide PA6. All items are no stock item and have a delivery time of 3 till 4 weeks.

## Spiral conduit type M.P.C. en M.P.U.

|                      |     |     |     |     |     |     |     |     |
|----------------------|-----|-----|-----|-----|-----|-----|-----|-----|
| Trade size MPC / MPU | NW  | 9   | 11  | 16  | 21  | 29  | 36  | 48  |
| Fittings             | ISO | M16 | M20 | M25 | M32 | M40 | M50 | M63 |
|                      | PG  | 9   | 11  | 16  | 21  | 29  | 36  | 48  |

### MPC : All-plastic spiral conduit reinforced with a plastified metal spiral

Type MPC is an all-plastic conduit for light and normal mechanical strength. The MPC is very flexible and has a low bending radius. Type MPC is especially for static applications such as light machinery and installations, switchboxes, machine-/ apparatus-building and in the transport industry.

Construction : All-plastic, PVC, reinforced with plastified metal spiral.  
 Resistant against : Fuels, oils, bases and acids.  
 Temperature range : -20°C till +80°C.  
 Colour : Grey.

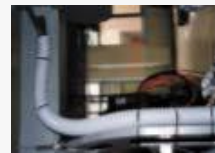

|                         |    |           |           |           |           |           |           |           |
|-------------------------|----|-----------|-----------|-----------|-----------|-----------|-----------|-----------|
| Trade size MPC          | NW | 9         | 11        | 16        | 21        | 29        | 36        | 48        |
| Inside diameter         | mm | 10        | 13        | 16        | 21        | 30        | 38        | 48        |
| Outside diameter        | mm | 14        | 17        | 21        | 27        | 36        | 45        | 56        |
| Bending radius (static) | mm | 14        | 17        | 21        | 27        | 36        | 45        | 56        |
| Standard carton         | m  | 50        | 50        | 50        | 50        | 25        | 25        | 25        |
| Article No. grey        |    | 620.309.0 | 620.311.0 | 620.316.0 | 620.321.0 | 620.329.0 | 620.336.0 | 620.348.0 |
| Small carton            | m  | 10        | 10        | 10        | 10        | 10        | 10        | 10        |
| Article No. grey        |    | 620.309.1 | 620.311.1 | 620.316.1 | 620.321.1 | 620.329.1 | 620.336.1 | 620.348.1 |



### MPU : Polyurethane spiral conduit reinforced with a plastified metal spiral

Type MPU is a Polyurethane conduit for light and normal mechanical strength. The MPU is very flexible and has a low bending radius. Type MPU is especially for static applications and high chemical resistance, such as light machinery and installations, switchboxes, machine-/ apparatus-building and in the transport industry.

Construction : Polyurethane, reinforced with plastified metal spiral.  
 Resistant against : Weakners, mineral-oils, fuels, oils, bases and acids.  
 Temperature range: -40°C till +90°C.  
 Colour : Blue.

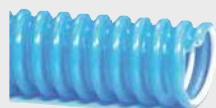

|                         |    |           |           |           |           |           |           |           |
|-------------------------|----|-----------|-----------|-----------|-----------|-----------|-----------|-----------|
| Trade size MPU          | NW | 9         | 11        | 16        | 21        | 29        | 36        | 48        |
| Inside diameter         | mm | 11        | 13        | 17        | 22        | 31        | 39        | 49        |
| Outside diameter        | mm | 14        | 17        | 21        | 27        | 36        | 45        | 56        |
| Bending radius (static) | mm | 14        | 17        | 21        | 27        | 36        | 45        | 56        |
| Standard carton         | m  | 50        | 50        | 50        | 50        | 25        | 25        | 25        |
| Article No. blue        |    | 620.409.0 | 620.411.0 | 620.416.0 | 620.421.0 | 620.429.0 | 620.436.0 | 620.448.0 |
| Small carton            | m  | 10        | 10        | 10        | 10        | 10        | 10        | 10        |
| Article No. blue        |    | 620.409.1 | 620.411.1 | 620.416.1 | 620.421.1 | 620.429.1 | 620.436.1 | 620.448.1 |



Special remarks:

- \* All sizes MPC and MPU in standard packaging are limited stock item. 10 meter lengths and larger volumes have a delivery time of 3 till 4 weeks.
- \* Longer lengths only on demand. Bigger or different sizes not available.

## fittings for type M.P.C. en M.P.U.

|            |     |     |     |     |     |     |     |     |
|------------|-----|-----|-----|-----|-----|-----|-----|-----|
| Trade size | mm  | 9   | 11  | 16  | 21  | 29  | 36  | 48  |
| Fittings   | ISO | M16 | M20 | M25 | M32 | M40 | M50 | M63 |
|            | PG  | 9   | 11  | 16  | 21  | 29  | 36  | 48  |

ISO straight swivel fitting, male, type AD-M, nickel plated thread, IP 40



|                    |      |           |           |           |           |           |           |           |
|--------------------|------|-----------|-----------|-----------|-----------|-----------|-----------|-----------|
| ISO thread         |      | M16x1,5   | M20x1,5   | M25x1,5   | M32x1,5   | M40x1,5   | M50x1,5   | M63x1,5   |
| For size MPC / MPU |      | 9         | 11        | 16        | 21        | 29        | 36        | 48        |
| Standard pack.     | pcs. | 50        | 50        | 50        | 25        | 25        | 25        | 10        |
| Article No. grey   |      | 651.116.1 | 651.120.1 | 651.125.1 | 651.132.1 | 651.140.1 | 651.150.1 | 651.163.1 |

ISO straight swivel fitting, male, type AD-KM, nickel plated thread, IP 54



|                    |      |           |           |           |           |           |           |           |
|--------------------|------|-----------|-----------|-----------|-----------|-----------|-----------|-----------|
| ISO thread         |      | M16x1,5   | M20x1,5   | M25x1,5   | M32x1,5   | M40x1,5   | M50x1,5   | M63x1,5   |
| For size MPC / MPU |      | 9         | 11        | 16        | 21        | 29        | 36        | 48        |
| Standard pack.     | pcs. | 50        | 50        | 50        | 25        | 25        | 25        | 10        |
| Article No. grey   |      | 651.116.2 | 651.120.2 | 651.125.2 | 651.132.2 | 651.140.2 | 651.150.2 | 651.163.2 |

PG straight swivel fitting, male, type AD, nickel plated thread, IP 40



|                    |      |           |           |           |           |           |           |           |
|--------------------|------|-----------|-----------|-----------|-----------|-----------|-----------|-----------|
| PG thread          |      | 9         | 11        | 16        | 21        | 29        | 36        | 48        |
| For size MPC / MPU |      | 9         | 11        | 16        | 21        | 29        | 36        | 48        |
| Standard pack.     | pcs. | 50        | 50        | 50        | 25        | 25        | 25        | 10        |
| Article No. grey   |      | 650.109.1 | 650.111.1 | 650.116.1 | 650.121.1 | 650.129.1 | 650.136.1 | 650.148.1 |

PG straight swivel fitting, male, type AD-K, nickel plated thread, IP 54



|                    |      |           |           |           |           |           |           |           |
|--------------------|------|-----------|-----------|-----------|-----------|-----------|-----------|-----------|
| PG thread          |      | 9         | 11        | 16        | 21        | 29        | 36        | 48        |
| For size MPC / MPU |      | 9         | 11        | 16        | 21        | 29        | 36        | 48        |
| Standard pack.     | pcs. | 50        | 50        | 50        | 25        | 25        | 25        | 10        |
| Article No. grey   |      | 650.109.2 | 650.111.2 | 650.116.2 | 650.121.2 | 650.129.2 | 650.136.2 | 650.148.2 |

Box connector, straight swivel fitting, male, type AD-H, IP 40

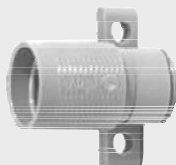

|                    |      |           |           |           |           |           |           |           |
|--------------------|------|-----------|-----------|-----------|-----------|-----------|-----------|-----------|
| Size NW            |      | 9         | 11        | 16        | 21        | 29        | 36        | 48        |
| For size MPC / MPU |      | 9         | 11        | 16        | 21        | 29        | 36        | 48        |
| Standard pack.     | pcs. | 50        | 50        | 50        | 25        | 25        | 25        | 10        |
| Article No. grey   |      | 650.309.3 | 650.311.3 | 650.316.3 | 650.321.3 | 650.329.3 | 650.336.3 | 650.348.3 |

fittings for MPC and MPU

All types fittings are made from PA6, temperature range -35°C till + 80°C. fittings are limited on stock, for larger volumes please notice a delivery time of 3 till 4 weeks.